



PALACE

RESIDENCES  
DUBAI HILLS ESTATE

EMAAR

EVERY DAY IS A CELEBRATION!!!

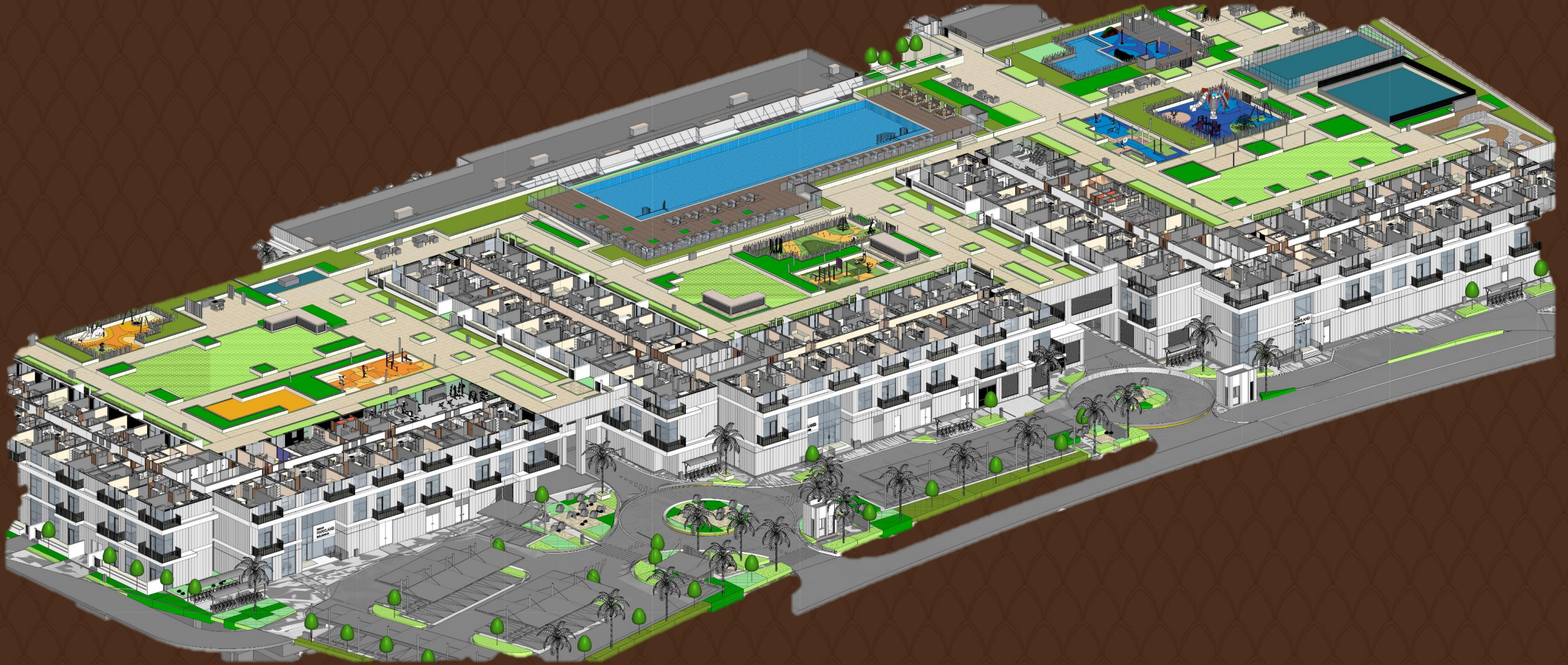

# LIVE LIFE KING-SIZE!!!

## MASSIVE PODIUM DECK SPREAD ACROSS 17,708 SQM!!!

### Legend

- ① Outdoor Lounge
  - ② Pergola
  - ③ Gazebo
  - ④ Outdoor tables and chair
  - ⑤ Flexible Natural lawn
  - ⑥ 50m Lap pool
  - ⑦ Kids Pool area
  - ⑧ Splash pad
  - ⑨ Kids Play area
  - ⑩ Half basketball court
  - ⑪ Padel court
  - ⑫ Sensory garden
  - ⑬ Outdoor fitness station
  - ⑭ Multi BBQ area
  - ⑮ Outdoor Yoga area
  - ⑯ Pool Deck
  - ⑰ Cabana
  - ⑱ Lift to Ground Floor
  - ⑲ Staircase to Ground Floor
  - ⑳ Table Tennis
  - ㉑ Sculpture
- Architectural extents

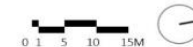

# PALACE

RESIDENCES  
DUBAI HILLS ESTATE

EMAAR

## PALACE BRANDED ONE BEDROOM APARTMENTS

- FULLY FITTED KITCHENS
- AVG SIZE – 754 SqFt



## PALACE BRANDED TWO BEDROOM APARTMENTS

- FULLY FITTED KITCHENS
- AVG SIZE – 1181 SqFt



## PALACE BRANDED THREE BEDROOM APARTMENTS

- FULLY FITTED KITCHENS
- AVG SIZE – 1540 SqFt



# INVENTORY – 620 UNITS AVAILABLE FOR SALE



**44%**



**41%**



**13%**



# BULK DEAL OPPORTUNITY

Building	Bedrooms	#Units	Total Area (Sqft)	Total Value (AED Mn)
	Half Floor	7	8,451	~20.60
	Full Floor	16	16,547	~39.51

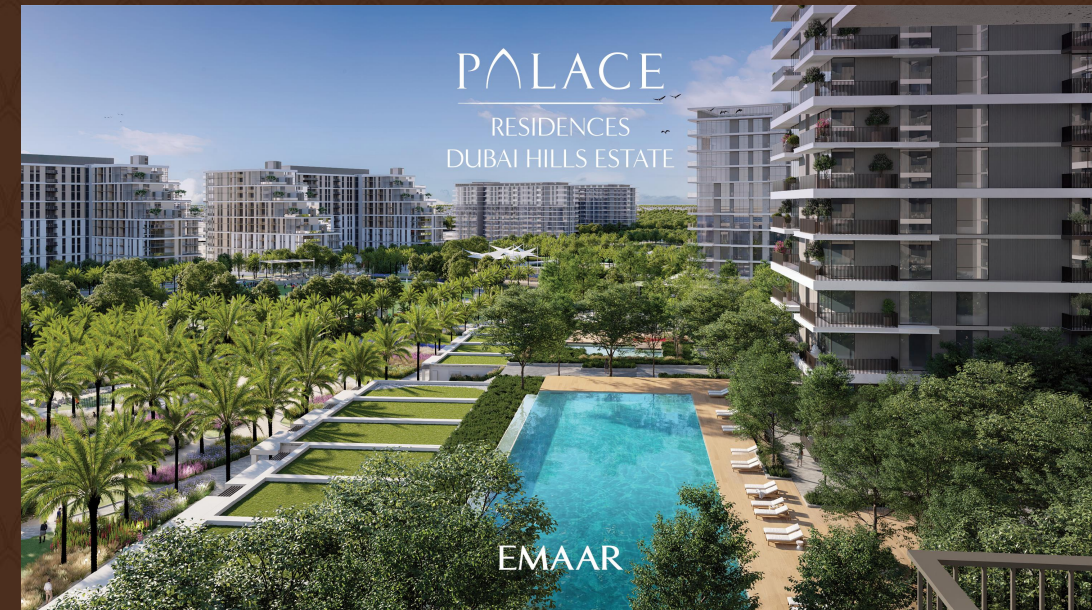

# COMMERCIALS



ONE BED

Avg Size

754 SqFt

Starting Price

AED 1.76 Mn

AED 2350 psf+

# COMMERCIALS



## TWO BED

Avg Size

1181 Sqft

Starting Price

AED 2.59 Mn

**AED 2200 psf+**

# COMMERCIALS

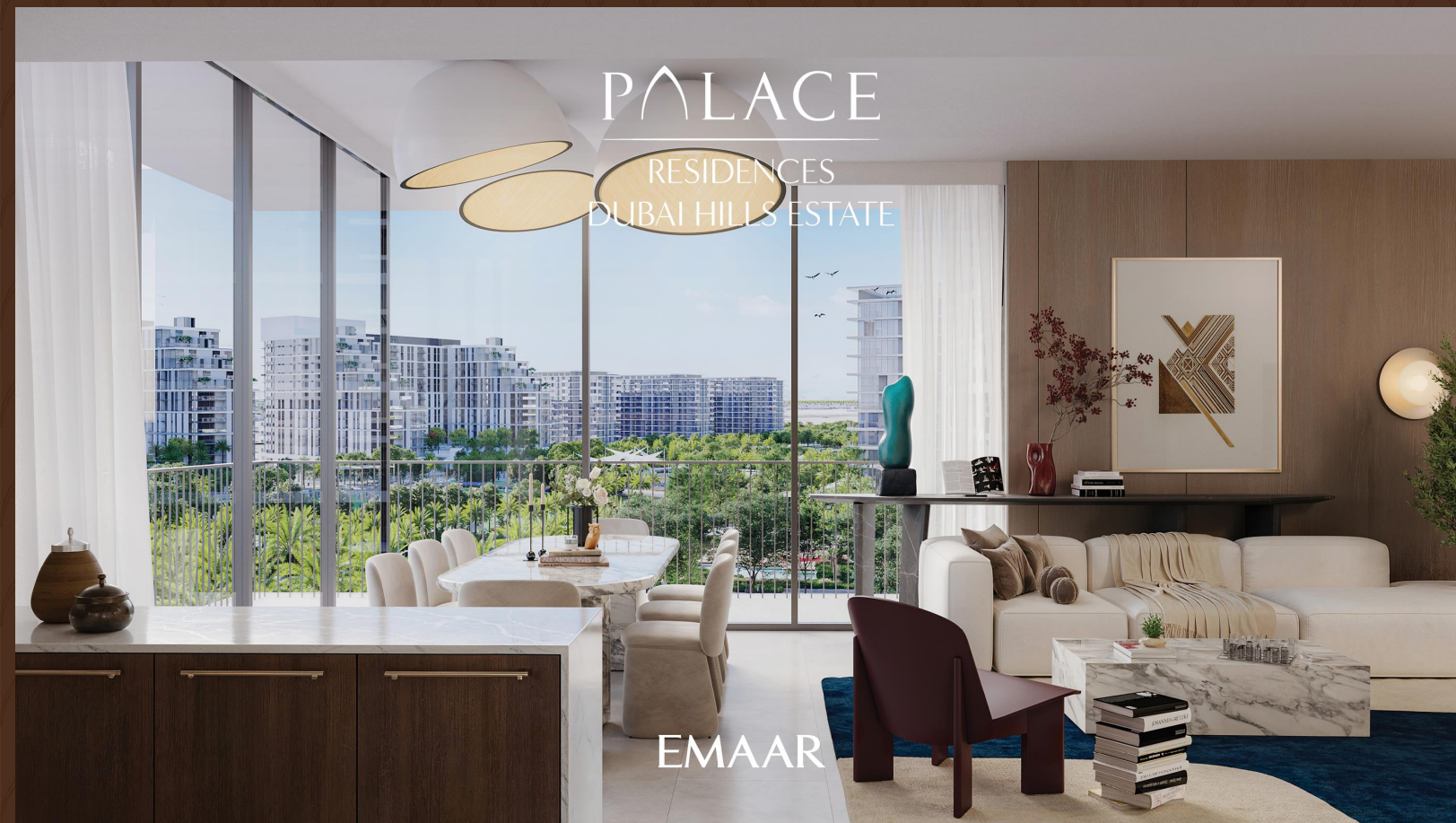

THREE BED

Avg Size

1,540 Sqft

Starting Price

AED 3.58 Mn

AED 2325 psf

# SPECIAL 20% YEARLY PAYMENT PLAN

2024 – 20%

2025 – 20%

2026 – 20%

2027 – 20%

HANDOVER April'28 – 20%

10%

DOWN PAYMENT

On Booking

10%

1st INSTALMENT

Jul. 2024

10%

2nd INSTALMENT

Jan. 2025

10%

3rd INSTALMENT

Jun. 2025

10%

4th INSTALMENT

Jan. 2026

Upon 20% Construction Completion\*

10%

5th INSTALMENT

Sep. 2026

Upon 40% Construction Completion\*

10%

6th INSTALMENT

Mar. 2027

Upon 60% Construction Completion\*

10%

7th INSTALMENT

Oct. 2027

Upon 80% Construction Completion\*

20%

8th INSTALMENT

Apr. 2028

Upon 100% Construction Completion\*



PALACE

RESIDENCES  
DUBAI HILLS ESTATE

EMAAR